

Cyanlite™
LED Panel Lights
BOLLO
for
Sports Applications







Overview

The Cyanlite™ LED panel lights BOLLO series has been designed specifically for Sport applications with IK10 and IP40 protection. The robust PC prismatic diffuser and up to 20,000 lumen output performance perfectly meet the requirements of the most indoor sports applications with high ceilings. BOLLO can be easily installed as Recessed, Surface Mounted and Suspended. 130lm/w High Efficiency ensures huge electricity savings and low operation cost.

Advantages

- Specifically designed for sports applications
- Easy and fast installation, saving installation cost
- Different Installations methods: Recessed, Surface Mounted and Suspended
- Flexible and customization oriented, bespoke sizes are welcome
- Professional LED lighting manufacturer, ODM for EU top lighting brands, no risk for partnership

Features

- Standard sizes (mm): 315x1540mm, 415x1540mm
- RAL9016 as standard coating color, other RAL colors available on request
- System Efficiency higher than 130 lm/W
- DIN 18032-3, EN 60598-2-22
- Range of color temperatures 3000K, 3500K, 4000K, 5000K & 6000K
- 5 Years Warranty
- Various dimming options, including 0-10V, DALI, Switch Dim etc.
- Emergency options available

Specifications



Part No.	Dimension (mm)	Power	Luminous Flux	Beam Angle
PB60W316B-SP	315x1540x96	60W	8000 lm	90°
PB90W316B-SP	315x1540x96	90W	12000 lm	90°
PB120W416B-SP	415x1540x96	120W	16000 lm	90°
PB150W416B-SP	415x1540x96	150W	20000 lm	90°



Accessory

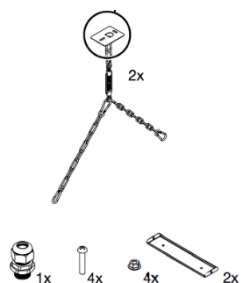

Suspension Kit ACC-SP-SUS-Y

Photometric

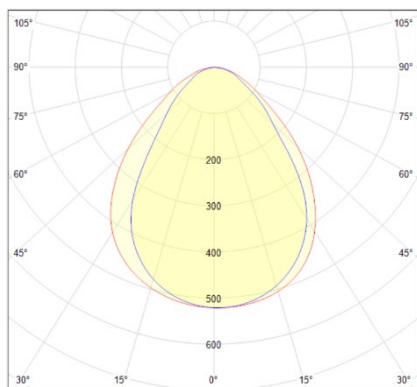

Beam Angle 90°

Dimensions (mm)

315x1540x96 model

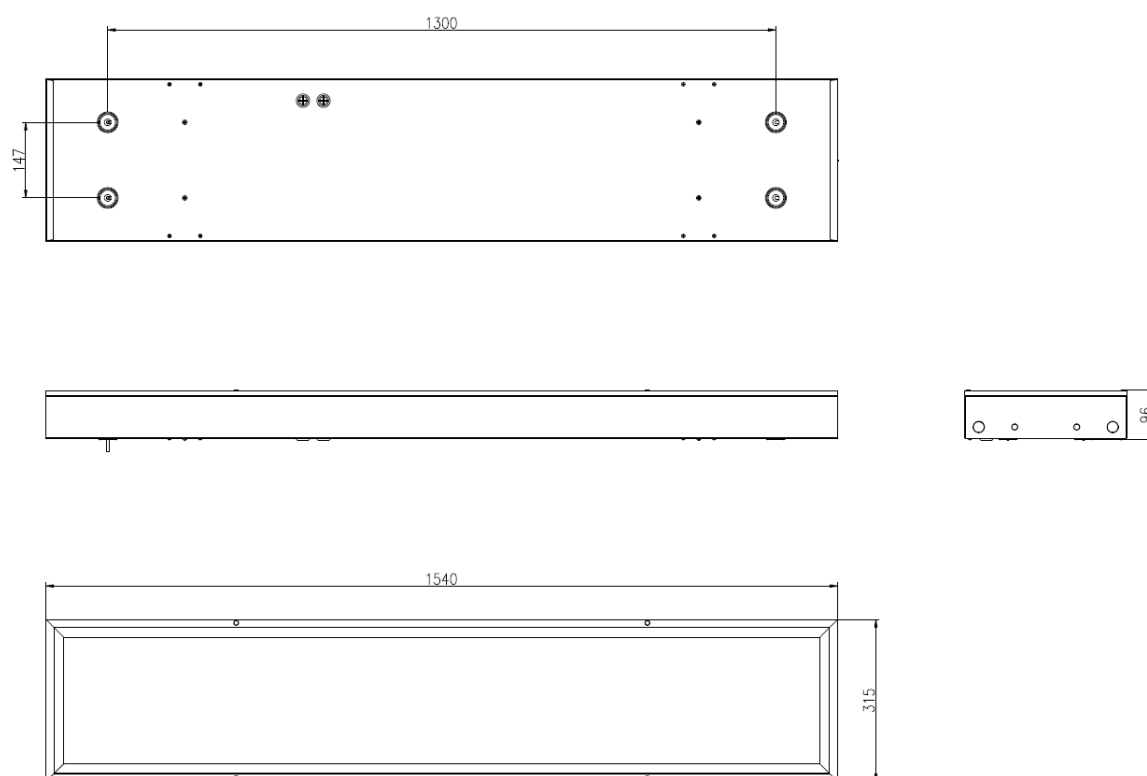

415x1540x96 model

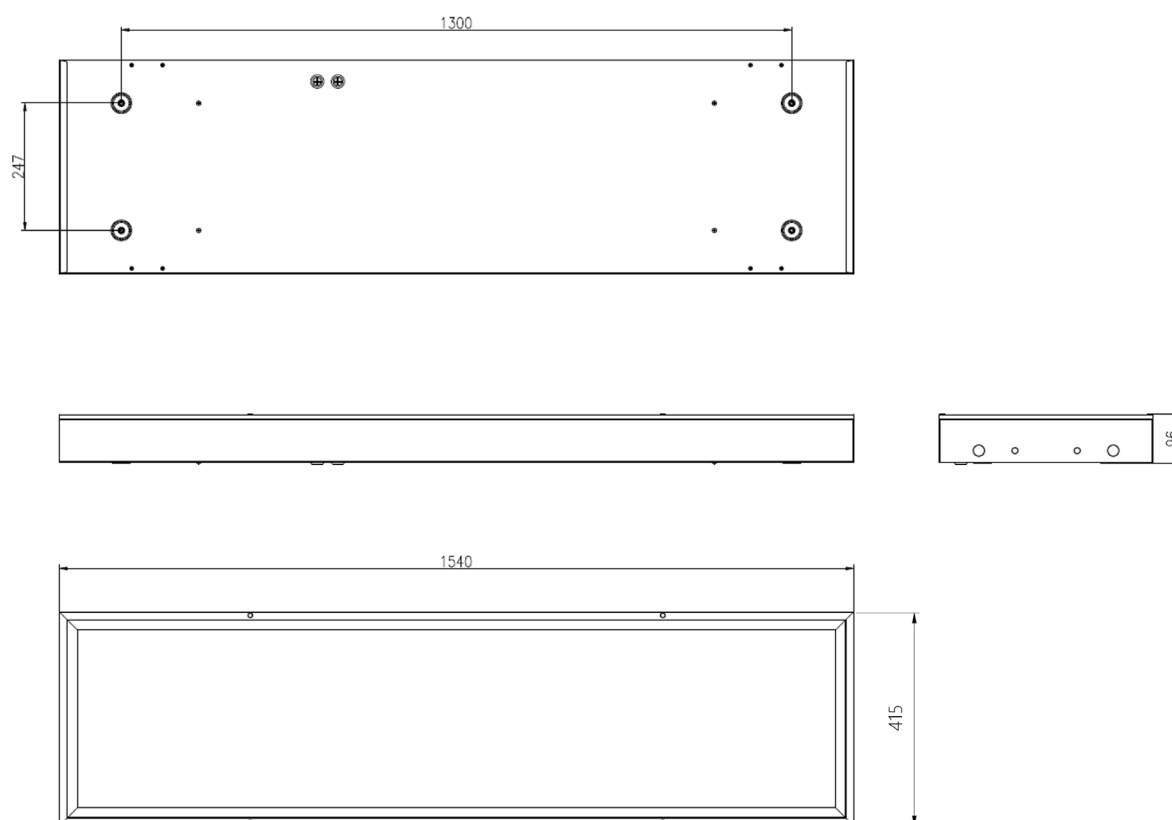

Installation

STEP 1

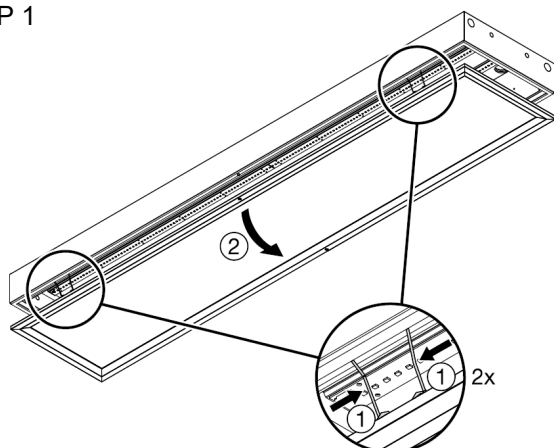

STEP 2

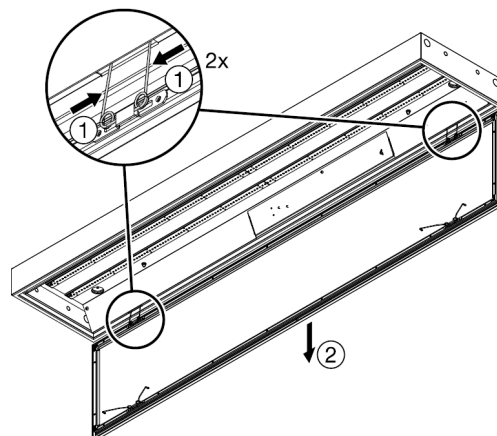

STEP 3

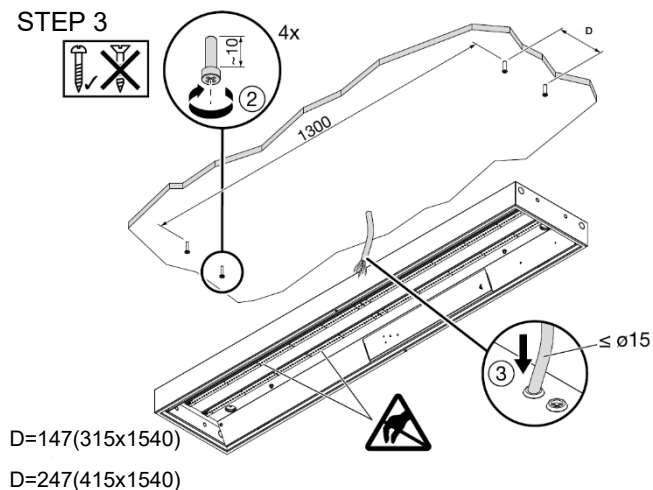

STEP 4

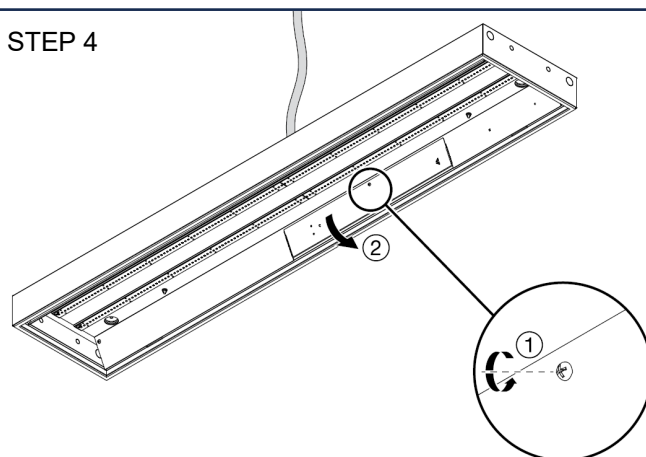

STEP 5

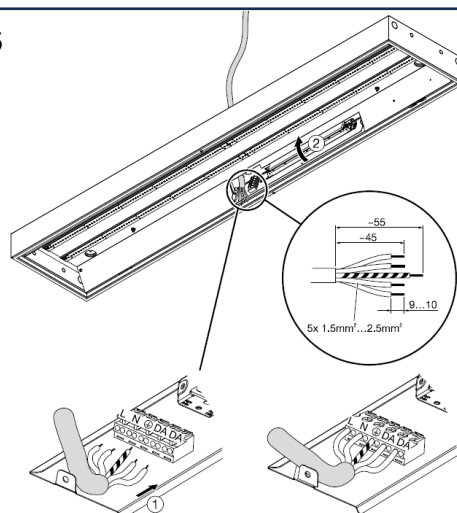

STEP 6

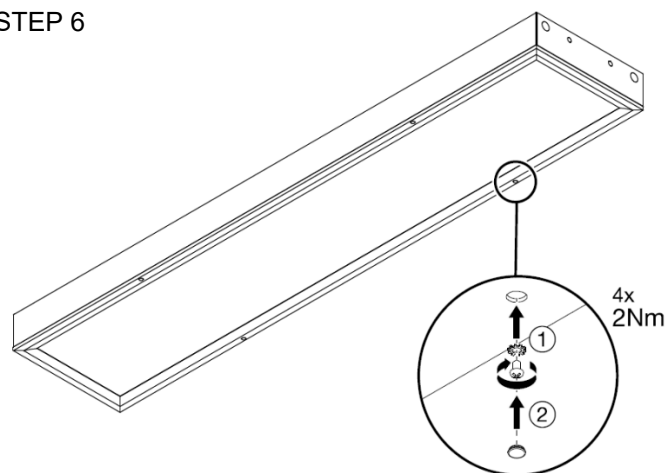

Efficacy	133lm/w ≥ 4000K
CRI (Ra)	>80 (>90 Optional)
Color Temp.	3000K/3500K/4000K/5000K/6000K
Lighting Method	Back-lite
Light Source	SMD2835
SDCM	<4
Beam Angel	90° Micro Prismatic Diffuser
Service Life	L80B10 (25°C) > 50.000h
IP Rating	IP40
Impact Resistance	IK10
Hot Wire Resistance	650°C
Driver	Flicker Free On/off driver as standard
Dimmable	1-10V, DALI, Push Dim, Bluetooth Optional
Nominal Frequency	50/60Hz
Power Factor	>0.9
Input Voltage	200~240V
Flick Free	Yes
Housing Color	RAL9016 White
Housing Material	Aluminum frame, Steel housing
LGD Material	Acrylic (PMMA)
Diffuser Material	Polycarbonate (PC)
Storage Temp.	-40°C~+80°C
Working Temp.	-20°C~+45°C
Mount	Surface mounted/Suspended/Recessed
Package	1pcs per carton
Warranty	5 years

According to the International Standard of LED luminaire, here Cyanlite formally claims this product is only allowed to be applied to indoor environment. Meanwhile Cyanlite promises full warranty for the products. Any severe environment application including high/low temperature, high humidity, high salinity, high ammonia etc. is not permitted without the official confirmation from the manufacturer. If any misapplication happens, the warranty policy is no longer guaranteed. All values are typical values measured under laboratory conditions at 25 °C. Specifications subject to change without notice.

Rev: 1.0 2025/01/01

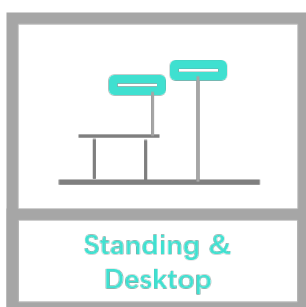
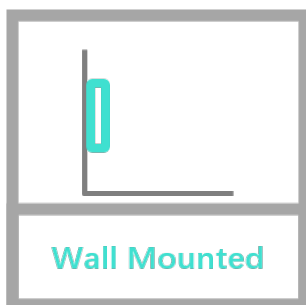
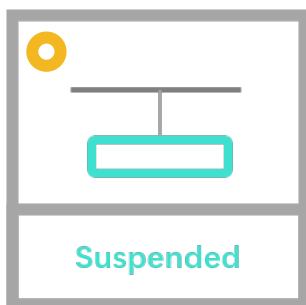
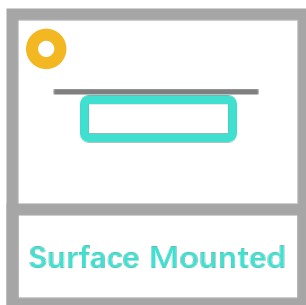
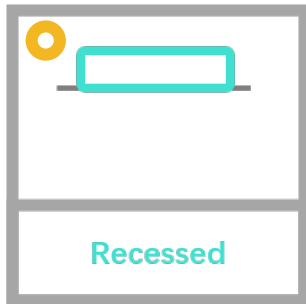

Cyanlite™
LED Luminaires
For
Recessed
Surface Mounted
Suspended
Wall Mounted
Standing & Desktop
Installations

www.cyanlite.com

