

Cyanlite™

NOVA

Architectural
LED Panel Lights

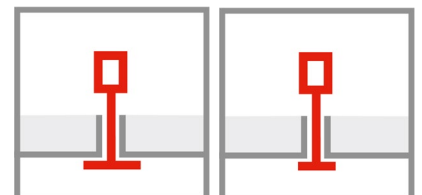

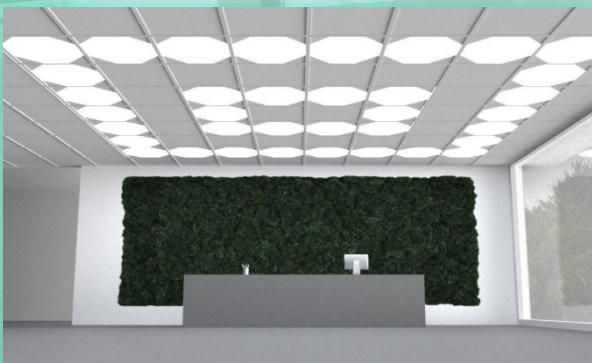

Cyanlite Novelty LED Backlit Panel Light-Nova Series

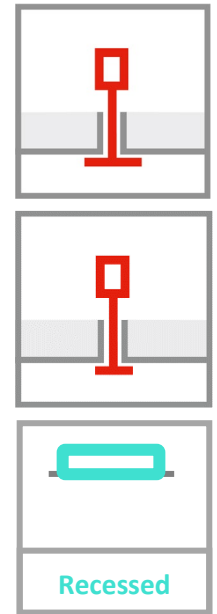
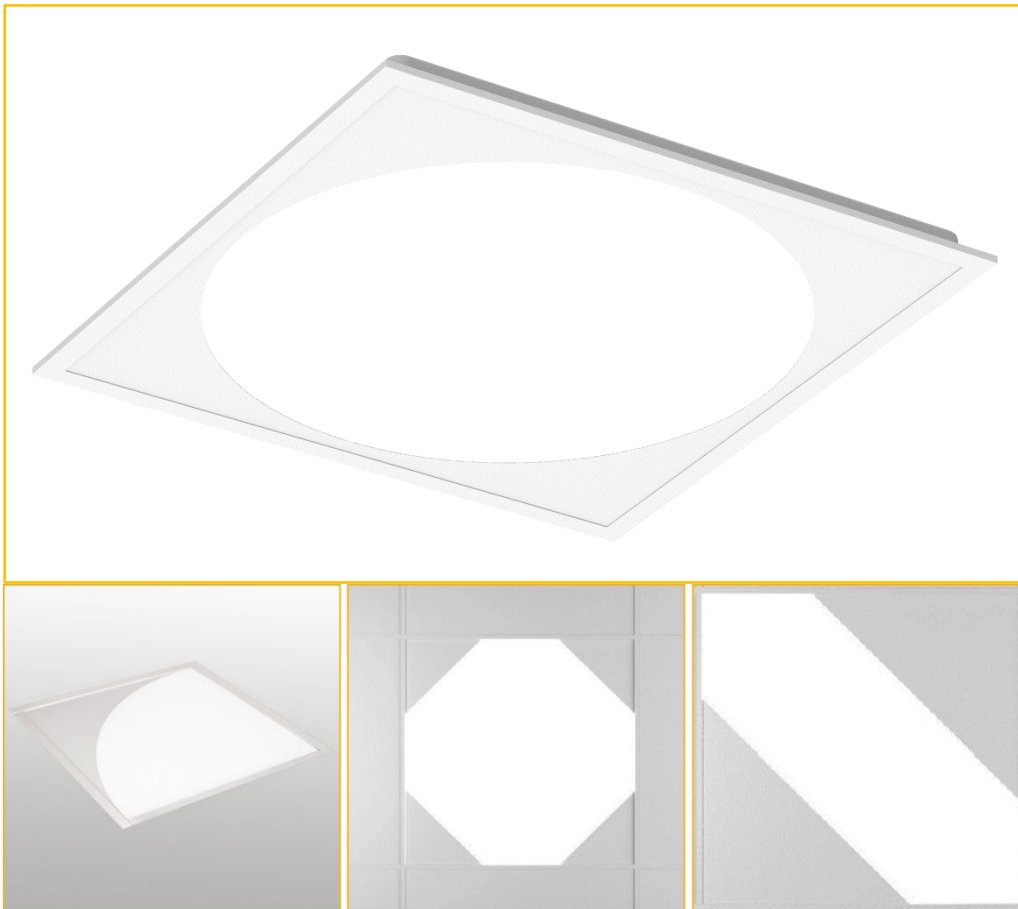

Overview

The Cyanlite™ Novelty LED Backlit panel lights Nova series are designed for high-end premium projects, especially for clients who are looking for differentiation. Inside the square panel, it comes with 4 luminous shapes, round, fan-shaped, diagonal and hexagon. This fully allows clients to choose and assemble patterns to their preferences. Adopting the benefit of LED Backlite technology, this luminaire has no light guide inside, no worry about yellowish problem compared with edge lit panel light. The aluminum frame is stylish and fashionable, stable, and with excellent thermal management. It could directly fit into the Lay-On ceiling systems perfectly, no need for extra accessories. Flicker free, on off as standard; 1-10V and DALI dimming are optional. A good product for office, hospital, school, shop, and other open planed location.

Bespoke sizes and shapes are available on request.

Advantages

- Different and stylish, freedom to create patterns as clients wants.
- No light guide, no yellowish problem.
- Needs no additional installation accessories, saving material cost
- Easy and fast installation, no additional job for screws or adjustment, saving installation cost
- A wide product range for all major standard Lay-on ceiling tile sizes
- Flexible and customization oriented, bespoke sizes are welcome
- Professional LED lighting manufacturer, ODM for EU top lighting brands, no risk for partnership

Features

- Standard sizes (mm): 600x600, 625x625
- RAL9016 as standard, other RAL colors available on request
- EN 12464-1& LG7 Compliant, UGR<19 Optional when fitted with Micro Prismatic diffuser
- Range of color temperatures 3000K, 3500K, 4000K, 5000K & 6000K
- 5 Years Warranty
- Various dimming options, including 0-10V, DALI, Switch Dim etc.
- Emergency options available

Specification



Model	Part No.	Power	Luminous Flux	Dimension (mm)
600x600	PB35W060P-N1	35 W	3500 lm	595x595x30
625x625	PB35W062P-N1	35 W	3500 lm	620x620x30
600x600	PB35W060P-N2	35 W	3500 lm	595x595x30
625x625	PB35W062P-N2	35 W	3500 lm	620x620x30
600x600	PB35W060P-N3	35 W	3500 lm	595x595x30
625x625	PB35W062P-N3	35 W	3500 lm	620x620x30
600x600	PB35W060P-N4	35 W	3500 lm	595x595x30
625x625	PB35W062P-N4	35 W	3500 lm	620x620x30

Assembly examples



Technical Data

CRI (Ra)	80
Color Temp.	3000K/3500K/3500K/5000K/6000K
Lighting Method	Backlite
Light Source	SMD2835
SDCM	<3
Beam Angel	110° Opalic Diffuser/ 90° Micro Prismatic Diffuser
Service Life	L80B10 (25°C) >= 50.000h
IP Rating	IP20
Impact Resistance	IK04
Hot Wire Resistance	650°C
Driver	Flicker Free On/off driver as standard
Dimmable	1-10V, DALI, Push Dim, Bluetooth Optional
Nominal Frequency	50/60Hz
Power Factor	>0.9
Input Voltage	200~235V
Flick Free	Yes
Housing Color	RAL9016 White
Housing Material	Aluminum frame, steel housing
Lens Material	Acrylic (PMMA)
Diffuser Material	Polystyrene (PS)
Storage Temp.	-35°C~+80°C
Working Temp.	-20°C~+45°C
Mount	Recessed
Package	2pcs per gift box, 6pcs per master box
Warranty	5 years

According to the International Standard of LED luminaire, here Cyanlite formally claims this product is only allowed to be applied to indoor environment. Meanwhile Cyanlite promises full warranty for the products. Any severe environment application including high/low temperature, high humidity, high salinity, high ammonia etc. is not permitted without the official confirmation from the manufacturer. If any misapplication happens, the warranty policy is no longer guaranteed. All values are typical values measured under laboratory conditions at 25 °C. Specifications subject to change without notice.

Rev: 1.5 2022/10/28

Cyanlite™

LED Panel Lights

For

Lay-In

● Lay-On

Clip-In

Hook-In

Hook-On

Hook-Over

Double Hook

Ceilings

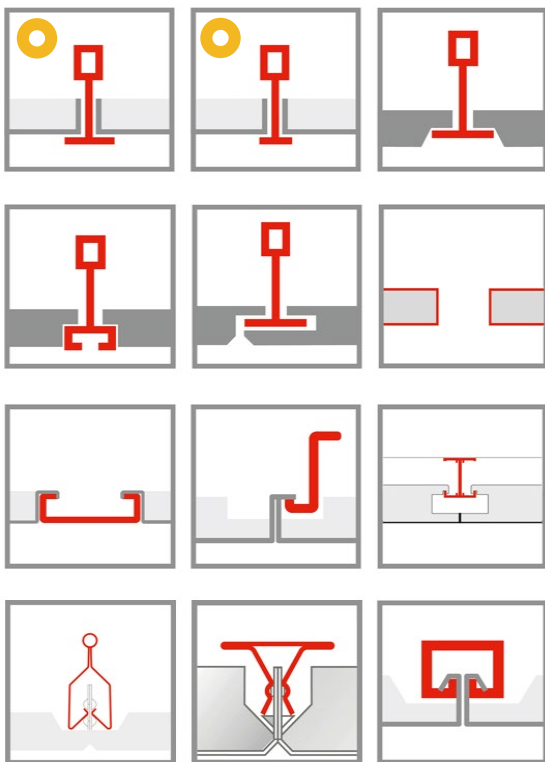

www.cyanlite.com

